

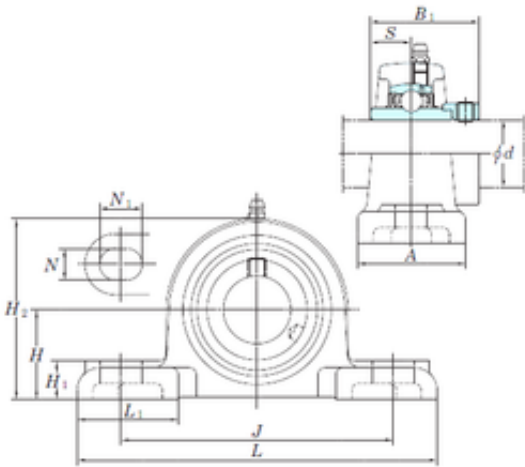

AMERICAN SKF BEARING MFG.CORP.

KOYO NAPK206-20 bearing units

Bearing No. NAPK206-20



NAPK206-20 Bearing 2D drawings and 3D CAD models

Bore Diameter	31.75 mm
d	31.75 mm
H	39,7 mm
A	48 mm
B1	48,4 mm
H1	17 mm
H2	80 mm
J	121 mm
L	160 mm
L1	45 mm
N	14 mm
N1	19 mm
S	18,3 mm
Bolt (G)	1/2
Weight	1,4 Kg
Basic dynamic load rating (C)	19,5 kN
Basic static load rating (C0)	11,3 kN